

# STI MANUFACTURING, INC.

## STYLE 5R

SHEATH TUBE TYPE RTD WITH ARMOR AND FLEXIBLE INSULATED LEAD WIRE FOR MAXIMUM OPERATING TEMPERATURE OF 400 DEG. F. 22 ga. LEAD WIRE STANDARD, OTHER GAUGES AVAILABLE.

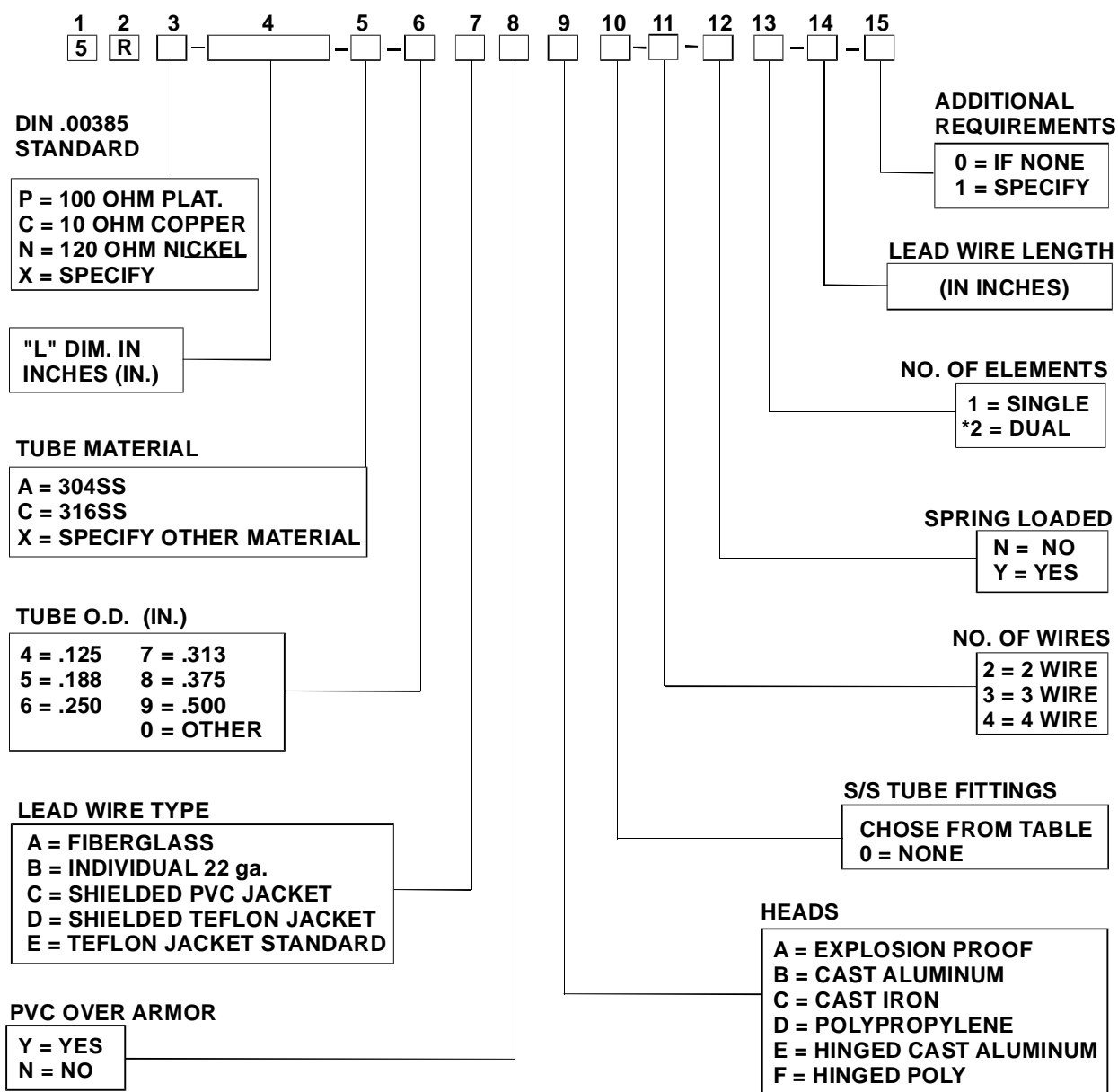
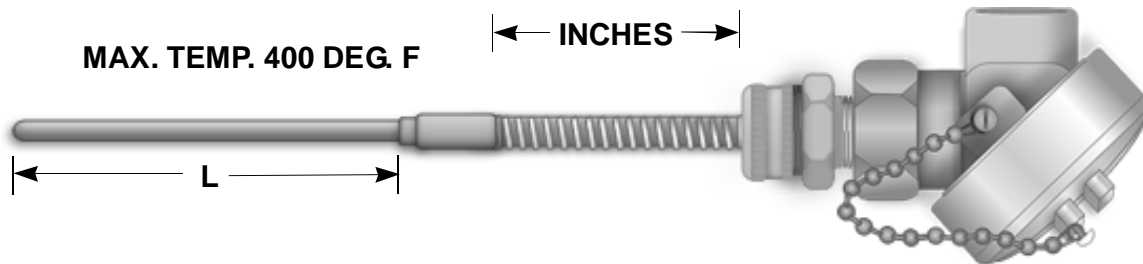

# STI MANUFACTURING, INC.

## STYLE 5R OPTIONS

### INDUSTRIAL RTD HEADS

3/4" NPT CONDUIT  
1/2" NPT INSTRUMENT



AVAILABLE MATERIALS  
CAST IRON  
CAST ALUMINUM  
POLYPROPYLENE  
\*STAINLESS STEEL  
\*SPECIAL ORDER

TERMINAL BLOCKS  
ARE CERAMIC PORCELAIN  
WITH BRASS TERMINALS

GROUND SCREWS  
ARE AVAILABLE-  
SPECIFY UNDER  
ADDITIONAL  
REQUIREMENTS

### EXPLOSION PROOF HEADS

3/4" NPT X 3/4" NPT PORTS  
\*1/2" OPTIONAL

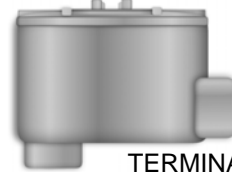

TERMINAL STRIPS  
ARE PHENOLIC

AVAILABLE MATERIALS  
CAST ALUMINUM

### INDUSTRIAL RTD HEADS HINGED TYPE -WEATHER TIGHT SEAL NEMA 4 RATING

3/4" NPT CONDUIT  
1/2" NPT INSTRUMENT



AVAILABLE MATERIALS  
CAST ALUMINUM  
POLYPROPYLENE

TERMINAL BLOCKS  
ARE CERAMIC PORCELAIN  
WITH BRASS TERMINALS

### EXPLOSION PROOF HEADS FMCSA CERTIFICATION NEMA 4 RATING

3/4" NPT CONDUIT  
1/2" NPT INSTRUMENT



AVAILABLE MATERIALS  
CAST ALUMINUM  
\*STAINLESS STEEL  
\*EPOXY COATED  
\*SPECIAL ORDER

TERMINAL BLOCKS  
ARE BAKELITE

### STANDARD HEX NIPPLE

1/2" NPT 316SS

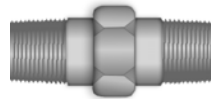

OTHER MATERIALS  
AND SIZES AVAILABLE

### WELD PADS



1" X 1" STANDARD  
SIZING AND BENDING OPTIONAL

### SPRING LOADING

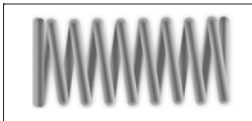

### REDUCED TIPS

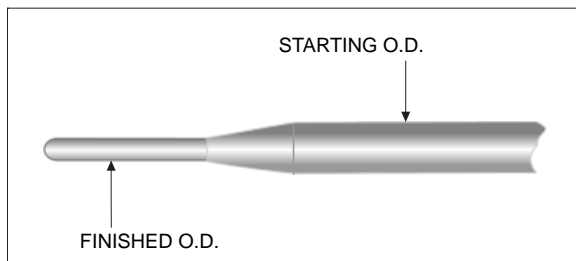

### TUBE TO PIPE FITTINGS STAINLESS STEEL STANDARD OTHER MATERIALS AVAILABLE

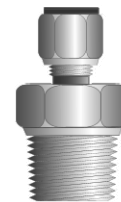

RTD O.D. X NPT	
1/8"	1/8" = 2
3/16"	1/4" = 3
1/4"	1/4" = 4
1/4"	1/2" = 6
3/8"	1/2" = 7
1/2"	1/2" = 8
IF VENTED = X	