

STI MANUFACTURING, INC.

STYLE 4A

SHEATH TYPE THERMOCOUPLE WITH REMOTE MOUNT HEAD, FLEXIBLE SS ARMOR, AND INSULATED LEAD WIRE 20 ga. STANDARD, OTHER GAUGES AVAILABLE

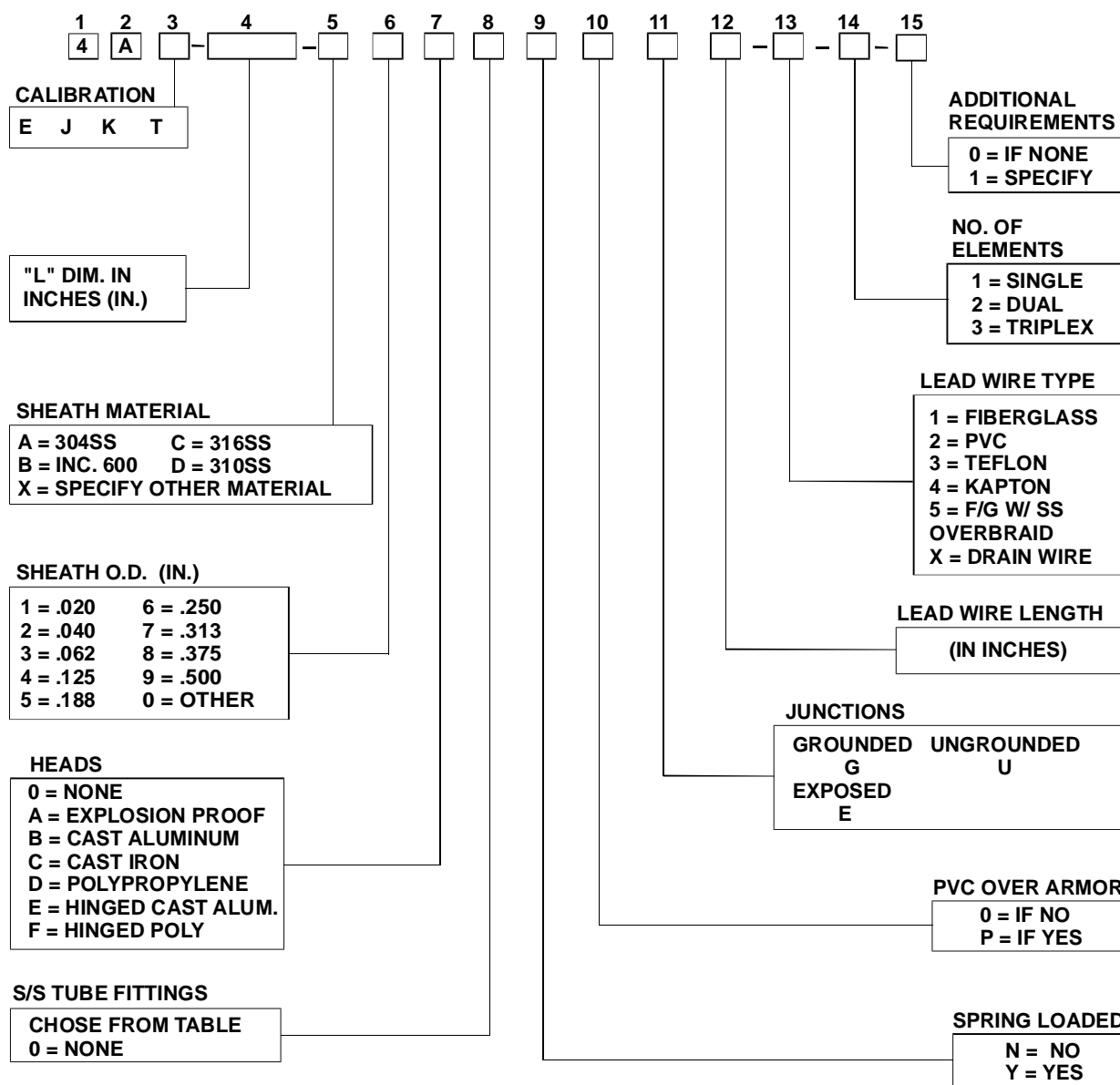
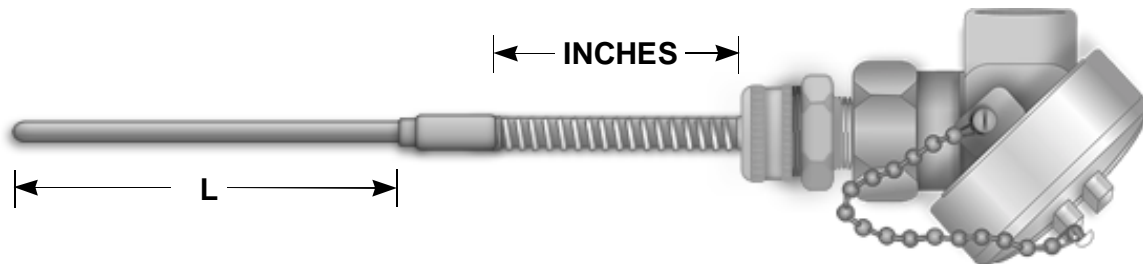

STI MANUFACTURING, INC.

STYLE 4A OPTIONS

INDUSTRIAL THERMOCOUPLE HEADS

3/4" NPT CONDUIT
1/2" NPT INSTRUMENT



AVAILABLE MATERIALS
CAST IRON
CAST ALUMINUM
POLYPROPYLENE
*STAINLESS STEEL
*SPECIAL ORDER

TERMINAL BLOCKS ARE CERAMIC PORCELAIN WITH BRASS TERMINALS

GROUND SCREWS ARE AVAILABLE - SPECIFY UNDER ADDITIONAL REQUIREMENTS

EXPLOSION PROOF HEADS

3/4" NPT X 3/4" NPT PORTS
*1/2" OPTIONAL

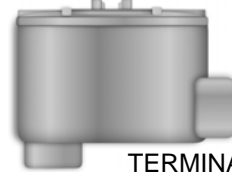

TERMINAL STRIPS ARE PHENOLIC

AVAILABLE MATERIALS
CAST ALUMINUM

INDUSTRIAL THERMOCOUPLE HEADS HINGED TYPE -WEATHER TIGHT SEAL NEMA 4 RATING

3/4" NPT CONDUIT
1/2" NPT INSTRUMENT



AVAILABLE MATERIALS
CAST ALUMINUM
POLYPROPYLENE

TERMINAL BLOCKS ARE CERAMIC PORCELAIN WITH BRASS TERMINALS

EXPLOSION PROOF HEADS FMCSA CERTIFICATION NEMA 4 RATING

3/4" NPT CONDUIT
1/2" NPT INSTRUMENT



AVAILABLE MATERIALS
CAST ALUMINUM
*STAINLESS STEEL
*EPOXY COATED
*SPECIAL ORDER

TERMINAL BLOCKS ARE BAKELITE

STANDARD HEX NIPPLE

1/2" NPT 316SS

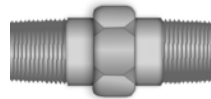

OTHER MATERIALS AND SIZES AVAILABLE

WELD PADS



1" X 1" STANDARD
SIZING AND BENDING OPTIONAL

SPRING LOADING

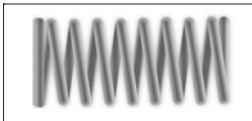

REDUCED TIPS

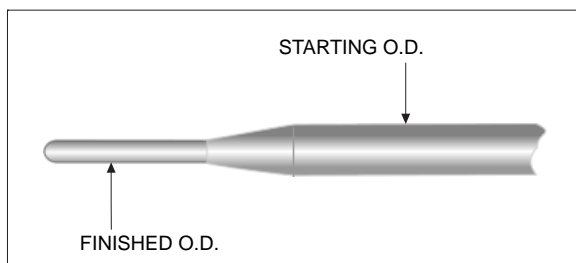

TUBE TO PIPE FITTINGS STAINLESS STEEL STANDARD OTHER MATERIALS AVAILABLE

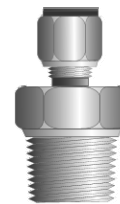

TC O.D. X NPT	
1/8"	1/8" = 2
3/16"	1/4" = 3
1/4"	1/4" = 4
1/4"	1/2" = 6
3/8"	1/2" = 7
1/2"	1/2" = 8
IF VENTED = X	